

Ref. **4834**

FRESA ESPECIAL HSSE 8% CO RANURAS WOODRUFF

Woodruff Slots HSSE 8% Co Shank Tool

Fraise Spéciale HSSE 8% Co Rainures Woodruff



HSSE 8% Co	HSSE 8% Co + TIALSIN	DIN 850 D N			Tol. D (h11) d (h8) l (e8)
---------------	----------------------------	-------------------	--	--	----------------------------------

* Ref. 4830 bajo demanda upon request sur demande

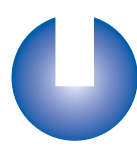
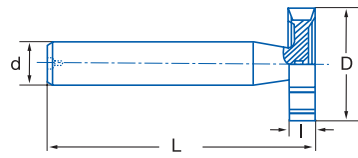

Grupo 1 Subgr. 1.1	Grupo 1 Subgr. 1.2	Grupo 3 Subgr. 3.1/3.2	Grupo 5 Subgr. 5.1/5.2	Grupo 6 Subgr. 6.1/6.2/6.3
-----------------------	-----------------------	------------------------------	------------------------------	----------------------------------

D mm	l mm	d mm	L mm	Z	Nº Art. 8% Co	€	Nº Art. TIALSIN	€	D mm	l mm	d mm	L mm	Z	Nº Art. 8% Co	€	Nº Art. TIALSIN	€
4,50	1,00	6	50	6	22506	39,13	22533	44,82	22,50	5,00	10	63	10	22520	56,24	22551	75,41
7,50	1,50	6	50	6	22507	40,73	22534	47,42	22,50	6,00	10	63	10	22522	56,24	22552	75,41
7,50	2,00	6	50	6	22509	40,73	22536	47,42	22,50	8,00	10	63	10	22524	56,24	22553	75,41
10,50	2,00	6	50	8	22521	43,84	22537	51,08	25,50	6,00	10	63	10	22525	65,61	22554	93,18
10,50	2,50	6	50	8	22523	43,84	22539	51,15	28,50	6,00	10	63	10	22527	66,76	22555	94,31
10,50	3,00	6	50	8	22510	43,84	22540	51,15	28,50	8,00	10	63	10	22528	66,76	22556	94,31
13,50	3,00	10	56	8	22512	44,54	22542	53,76	28,50	10,00	10	71	12	22373	66,76	22557	94,31
13,50	4,00	10	56	8	22513	44,54	22543	53,76	32,50	7,00	12	71	12	22374	82,71	22558	113,02
16,50	3,00	10	56	8	22514	44,94	22545	57,44	32,50	8,00	12	71	12	22530	82,71	22560	113,02
16,50	4,00	10	56	8	22515	44,94	22546	57,44	32,50	10,00	12	71	12	22531	82,71	22563	113,02
16,50	5,00	10	56	8	22516	44,94	22547	57,44	45,50	10,00	12	71	12	22532	130,95	22564	185,71
19,50	4,00	10	63	10	22517	51,16	22548	64,81									
19,50	5,00	10	63	10	22518	51,16	22549	64,81									
19,50	6,00	10	63	10	22519	51,16	22550	64,81									

Ref. **5080**

FRESA ESPECIAL HSSE 8% CO RADIO 1/4

1/4 Radius HSSE 8% Co Shank Tool

Fraise Spéciale HSSE 8% Co Rayon 1/4



HSSE 8% Co	HSSE 8% Co + TIALSIN	DIN 6518 B N	Serie Corta Short Length Série Courte		Tol. R (H11) d2 (h6)	1/4
---------------	----------------------------	--------------------	---------------------------------------------	--	----------------------------	-----

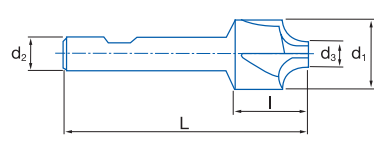

Grupo 1 Subgr. 1.1	Grupo 1 Subgr. 1.2	Grupo 3 Subgr. 3.1/3.2	Grupo 5 Subgr. 5.1/5.2	Grupo 6 Subgr. 6.1/6.2/6.3
-----------------------	-----------------------	------------------------------	------------------------------	----------------------------------

R	d3 mm	d1 mm	d2 mm	L mm	l mm	Z	Nº Art. 8% Co	€	Nº Art. TIALSIN	€
1,00	6,00	10,00	10	60		4	77762	45,57	19925	60,43
1,60	6,00	10,00	10	60		4	77763	41,49	19379	56,46
2,00	6,00	10,00	10	60		4	77764	36,47	18048	51,56
2,50	6,00	11,00	10	60	8	4	77765	41,90	19928	58,28
3,00	6,00	12,00	12	60		4	77766	41,90	18049	58,28
4,00	6,00	14,00	12	60	10	4	77767	46,37	18052	64,83
5,00	6,00	16,00	12	60	10	4	77768	52,90	17591	74,58
6,00	8,00	20,00	16	67	12	4	77769	52,90	18056	79,92
7,00	8,00	22,00	16	71	16	4	77770	72,43	19934	109,62
8,00	8,00	24,00	16	71	16	4	77771	72,43	17593	109,62
9,00	8,00	26,00	25	85	18	4	77772	94,38	19946	147,36
10,00	8,00	28,00	25	85	18	4	77773	94,38	19952	147,36
12,00	10,00	34,00	25	90	24	4	77774	103,34	19953	162,13
12,50	16,00	41,00	25	100	28	6	77775	117,18	19954	224,40
16,00	16,00	48,00	25	100	28	6	77776	200,14	19956	305,08
20,00	16,00	56,00	32	112	32	6	77777	290,48	21999	392,91

Ref. **4330**

FRESA ESPECIAL HSSE 8% CO ANGULAR

Single Angle HSSE 8% Co Shank Tool

Fraise Spéciale HSSE 8% Co Conique



HSSE
8% Co

HSSE
8% Co +
TIALSIN

DIN
1833 A
N

ISO
3859



Tol.
D (js16)
d (h8)

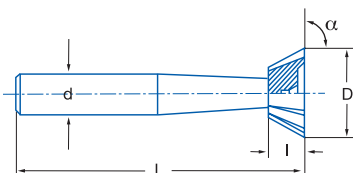

Grupo 1
Subgr. 1.1

Grupo 1
Subgr. 1.2

Grupo 3
Subgr.
3.1/3.2

Grupo 5
Subgr.
5.1/5.2

Grupo 6
Subgr.
6.1/6.2/6.3



D mm	Ang.	d mm	L mm	I mm	Z	N° Art. 8% Co	€	N° Art. TIALSIN	€
16,00	45°	12	60	4,00	8	58656	72,99	19628	94,13
20,00	45°	12	63	5,00	8	58674	77,65	22407	104,01
25,00	45°	12	67	6,30	10	58701	94,68	22405	131,25
32,00	45°	16	71	8,00	12	58719	105,64	22406	158,30
16,00	60°	12	60	6,30	8	58665	72,99	21549	94,13
20,00	60°	12	63	8,00	8	58683	77,65	17857	104,01
25,00	60°	12	67	10,00	10	58710	94,68	17923	131,25
32,00	60°	16	71	12,50	12	58728	105,64	21469	158,30

Ref. **4340**

FRESA ESPECIAL HSSE 8% CO ANGULAR

Single Angle HSSE 8% Co Shank Tool

Fraise Spéciale HSSE 8% Co Conique



HSSE
8% Co

HSSE
8% Co +
TIALSIN

DIN
1833 B
N

ISO
3859



Tol.
D (js16)
d (h8)

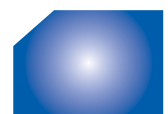
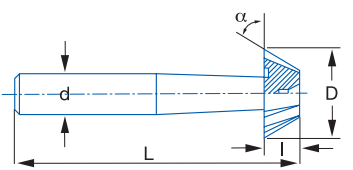

Grupo 1
Subgr. 1.1

Grupo 1
Subgr. 1.2

Grupo 3
Subgr.
3.1/3.2

Grupo 5
Subgr.
5.1/5.2

Grupo 6
Subgr.
6.1/6.2/6.3

D mm	Ang.	d mm	L mm	I mm	Z	N° Art. 8% Co	€
16,00	45°	12	60	4,00	8	58737	58,77
20,00	45°	12	63	5,00	8	58764	66,10
25,00	45°	12	67	6,30	10	58791	74,32
32,00	45°	16	71	8,00	12	58818	84,50
16,00	60°	12	60	6,30	8	58746	58,77
20,00	60°	12	63	8,00	8	58773	66,10
25,00	60°	12	67	10,00	10	58800	74,32
32,00	60°	16	71	12,50	12	58827	84,50

Ref. **4740**

FRESA ESPECIAL HSSE 8% CO MATRICERIA NZ

NZ Die-Sinking HSSE 8% Co Shank Tool
Fraise Spéciale HSSE 8% Co Matrices NZ

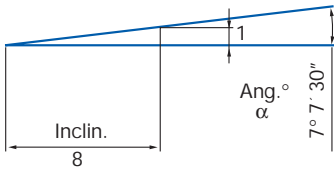
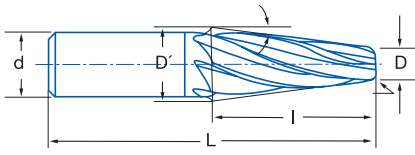

HSSE 8% Co	DIN 1889 EA N	ISO 3940		4-5 Z	
------------	---------------	----------	--	-------	--

		Tol. D (k12) d (h6)	Cónica Matricería Die-Sinking Tapered Conique pour Matrices
--	--	---------------------	-------------------------------------------------------------------

Grupo 1 Subgr. 1.1	Grupo 1 Subgr. 1.2	Grupo 3 Subgr. 3.1/3.2	Grupo 5 Subgr. 5.1/5.2	Grupo 6 Subgr. 6.1/6.2/6.3
------------------------------	------------------------------	----------------------------------	----------------------------------	--------------------------------------

D mm	I mm	d mm	Ang. α	Inclinación Inclination Inclinaison	D' mm	L mm	Z	Nº Art. 8% Co	€
4,00	56,00	20	9° 28'	1:6	22,70	120	4	46778	152,71
6,00	63,00	25	9° 28'	1:6	27,00	135	4	46796	185,83
8,00	71,00	32	9° 28'	1:6	31,70	145	4	46805	250,48
4,00	50,00	16	7° 7'	1:8	16,50	109	4	46775	83,59
6,00	56,00	20	7° 7'	1:8	20,00	120	4	46784	110,06
8,00	56,00	20	7° 7'	1:8	22,00	120	4	46799	146,13
12,00	63,00	25	7° 7'	1:8	27,80	135	4	46814	192,27
4,00	63,00	16	5° 43'	1:10	16,60	125	4	46781	99,72
6,00	63,00	16	5° 43'	1:10	18,60	125	4	46793	115,07
8,00	71,00	20	5° 43'	1:10	22,20	135	4	46802	149,68
12,00	71,00	25	5° 43'	1:10	26,20	140	4	46817	193,85
16,00	80,00	32	5° 43'	1:10	32,00	155	4	46826	251,39

D mm	I mm	d mm	Ang. α	Inclinación Inclination Inclinaison	D' mm	L mm	Z	Nº Art. 8% Co	€
20,00	100,00	32	5° 43'	1:10	40,00	175	5	46838	330,45
4,00	50,00	12	4° 34'	1:12,5	12,00	90	4	46772	79,24
6,00	63,00	16	4° 34'	1:12,5	16,00	112	4	46790	92,79
8,00	75,00	20	4° 34'	1:12,5	20,00	125	4	46808	140,43
12,00	81,00	25	4° 34'	1:12,5	25,00	140	4	46823	172,82
16,00	100,00	32	4° 34'	1:12,5	32,00	180	4	46832	280,25
6,00	63,00	10	2° 52'	1:20	12,30	115	4	46787	89,38
8,00	80,00	16	2° 52'	1:20	16,00	138	4	46811	109,49
12,00	80,00	20	2° 52'	1:20	20,00	140	4	46820	149,27
16,00	90,00	25	2° 52'	1:20	25,00	160	4	46829	174,95
20,00	100,00	25	2° 52'	1:20	30,00	170	5	46835	218,75

Ref. **4782**

FRESA ESPECIAL HSSE 8% CO MATRICERIA 2Z LARGA

Long 2Z Die-Sinking HSSE 8% Co Shank Tool
Fraise Spéciale HSSE 8% Co Matrices 2Z Longue

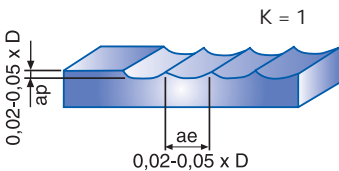
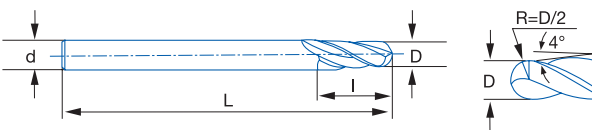

HSSE 8% Co	Cónica Tapered Conique	IZAR Std. N
------------	------------------------	-------------

ISO 3940		2 Z		
----------	--	-----	--	--

	Tol. d (h6)	Radial Matricería Ball-Ended Tapered Spherique pour Matrices
--	-------------	--------------------------------------------------------------------

Grupo 1 Subgr. 1.1	Grupo 1 Subgr. 1.2	Grupo 3 Subgr. 3.1/3.2	Grupo 5 Subgr. 5.1/5.2	Grupo 6 Subgr. 6.1/6.2/6.3
------------------------------	------------------------------	----------------------------------	----------------------------------	--------------------------------------

D mm	d mm	L mm	I mm	Ang. α	Z	Nº Art. 8% Co	€
3,00	10	200	52	4°	2	46862	88,98
4,00	10	200	50	4°	2	46865	88,98
5,00	10	200	38	4°	2	46868	88,98
6,00	12	200	46	4°	2	46871	98,55
7,00	12	200	39	4°	2	46874	118,04
8,00	14	200	47	4°	2	46877	115,45

D mm	d mm	L mm	I mm	Ang. α	Z	Nº Art. 8% Co	€
10,00	16	200	48	4°	2	46880	119,46
12,00	20	200	63	4°	2	46883	175,14
16,00	25	200	72	4°	2	46886	284,48
20,00	25	200	100	4°	2	46889	306,54
24,00	25	200	100	4°	2	46892	336,38

Ref. 4782 hasta fin de existencias / while Ex-stock / jusqu'à la fin de stock



Comprometidos con la fabricación y el empleo izartool.com Committed to manufacturing and jobs